

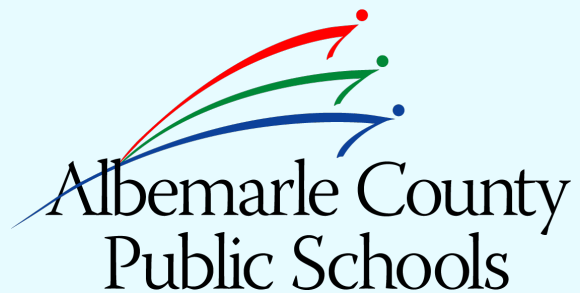

# AHS 2<sup>nd</sup> Floor Connector Design Development

March 14, 2024



# Strategic Plan: Learning for All

## VISION

Our learners are engaged in authentic, challenging, and relevant learning experiences, becoming lifelong contributors and leaders in our dynamic and diverse society.

## MISSION

Working together as a team, we will end the predictive value of race, class, gender, and special capacities for our children's success through high-quality teaching and learning for all. We seek to build relationships with families and communities to ensure that every student succeeds.

**We will know every student.**

## VALUES

Equity  
Excellence  
Family and Community  
Wellness

## GOALS



Thriving Students



Affirming and Empowering Communities



Equitable, Transformative Resources

# PROPOSED ADDITION - AERIAL





# PROPOSED SECOND FLOOR PLAN

## DD Update:

-Restroom added to Teacher Workroom

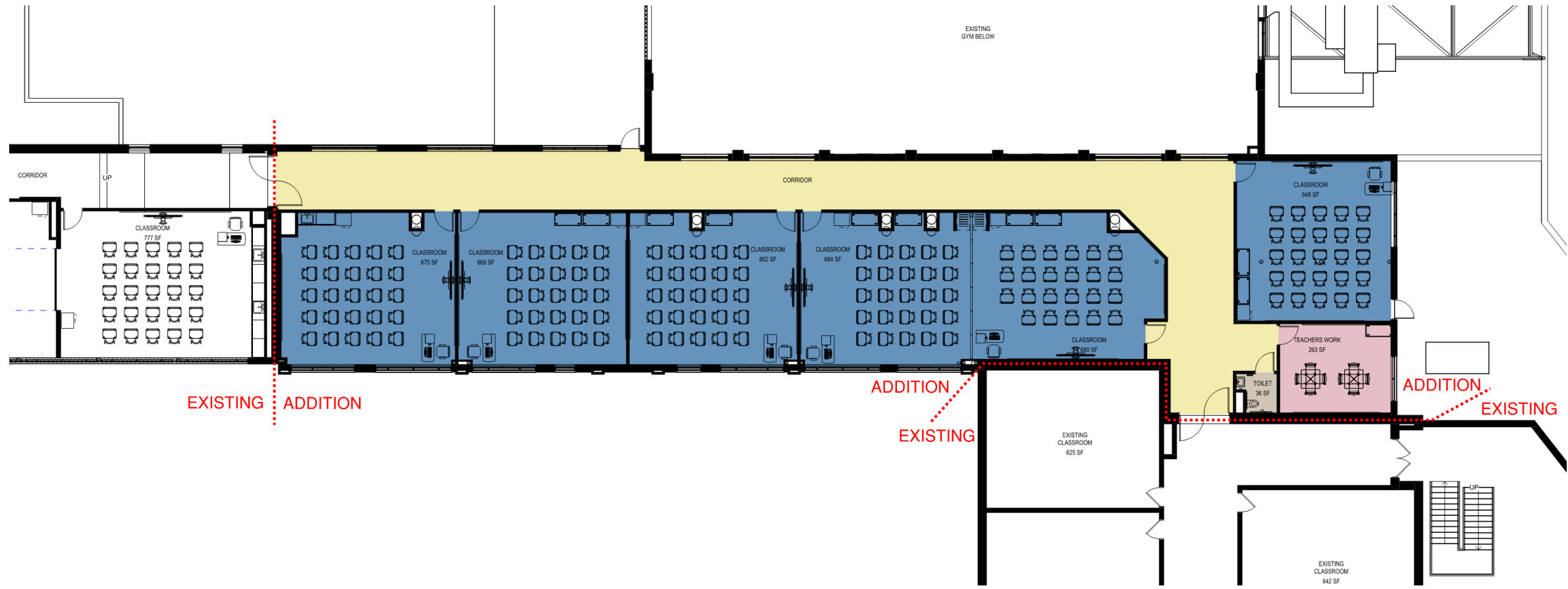

ENLARGED SECOND FLOOR PLAN

**DD Update:**

-Restroom added to Teacher Workroom

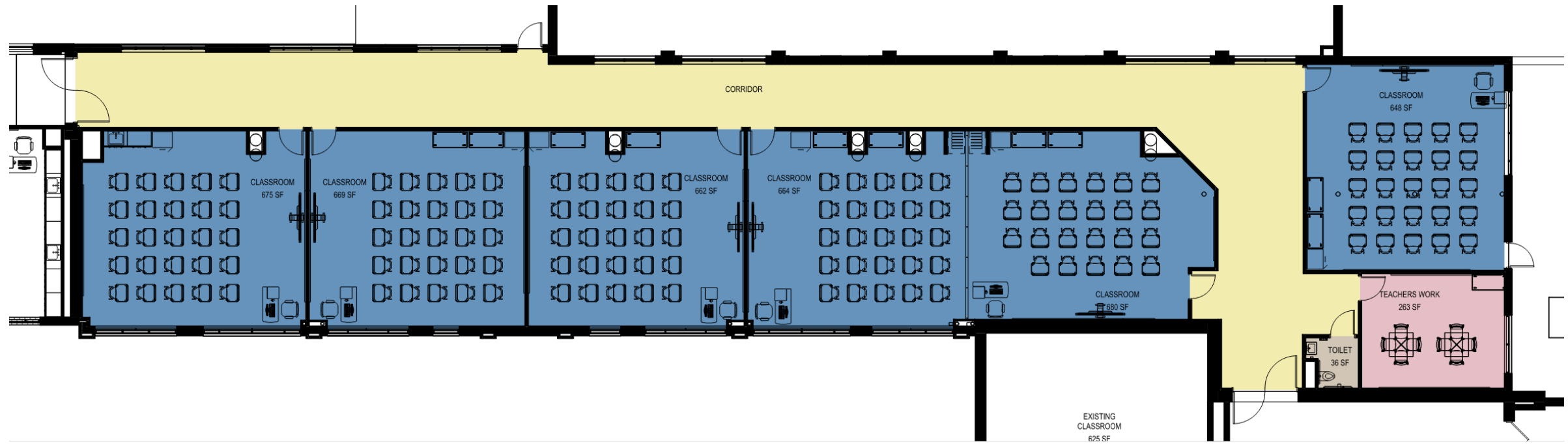

ENLARGED SECOND FLOOR PLAN

**DD Update:**  
-Windows into auxiliary gym preserved with views from corridor



WINDOWS INTO AUX. GYM

WINDOWS INTO AUX. GYM

**DD Updates:**

- Additive bid to add SPED restroom at first floor classroom
- Additive bid to add wall to create 2 smaller classrooms at first floor for added scheduling flexibility



ADD ALTERNATE 1 – FIRST FLOOR

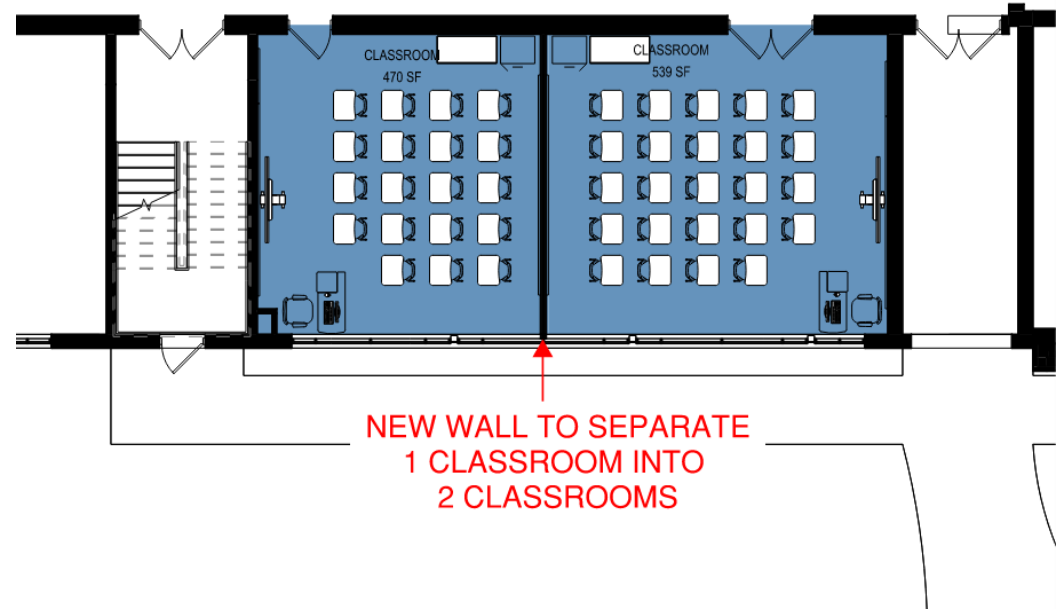

ADD ALTERNATE 2 – FIRST FLOOR

# BUILDING SECTION

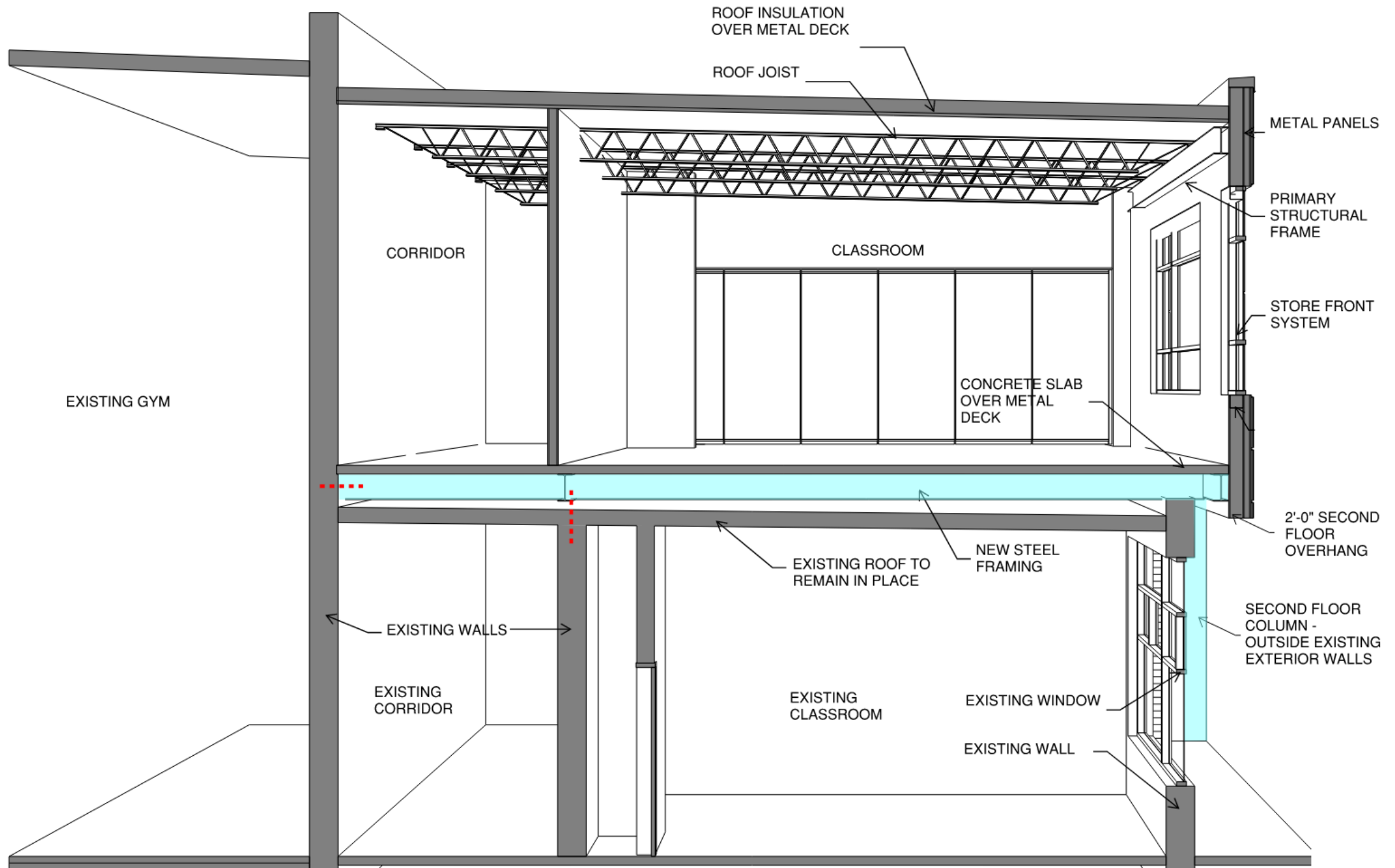









CR

COURTYARD EXTERIOR ELEVATION

# ALBEMARLE HIGH SCHOOL SECOND FLOOR CONNECTOR ADDITION

---

Addition	6,656 sf
Selective Renovations	605 sf

## PROJECT COSTS

---

CIP Construction Budget	\$4,500,000
DD Construction Cost Estimate	\$4,371,800 (\$624.54/sf)



**ALBEMARLE COUNTY HIGH SCHOOL**

**2ND FLOOR CONNECTOR ADDITION**

	2023	2024												2025		
Task	Dec	Jan	Feb	Mar	Apr	May	Jun	Jul	Aug	Sep	Oct	Nov	Dec	Jan	Feb	Mar
Schematic Design																
Design Development																
Construction Documents																
Bidding / Contracts																
Construction																
Final Completion / Occupancy																



# Contingency Planning

If Phase I work planned for Summer 2024 is behind schedule:

- Contractor would be limited to night and weekend work when the building is unoccupied to allow the first-floor classrooms under the addition to be occupied ASAP.
- If additive bid for the additional classroom wall is within budget, the additional classroom space would provide more scheduling flexibility.